

QT - Series (Quarter Turn Worm Gear Boxes)

The 'QT' series Quarter Turn Worm Gear Boxes are High Performance Gear Boxes used to operate Butterfly, Ball, Plug Valves & Dampers Manually.

PRODUCT DESCRIPTION:

- ◆ High Performance Gear Boxes by Robust Construction & Compact Design
- ◆ Meeting QUALITY, PERFORMANCE and DELIVERY.
- ◆ Torque range from 245 Nm to 73575 Nm.
- ◆ Output Travel - 0° to 90° (±5°)
- ◆ Self-locking Mechanism (Worm & Worm Wheel)
- ◆ Standard Version : Clockwise Input = Clockwise Output to Close
- ◆ IP-67 Enclosure
- ◆ Working Temperature -20°C to +120°C
- ◆ Graded Cast Iron Housing and Worm Wheel in Ductile Iron
- ◆ High Tensile Fasteners
- ◆ High performance Bearings
- ◆ Sturdy Hand wheel with Black Powder coating for Easy and Smooth Operation
- ◆ Semi-Glossy Black Epoxy Paint as Standard
- ◆ Gear Boxes lubricated with Multi-purpose Grease
- ◆ Gear Box Mounting as per ISO 5211 Std.

FEATURES:

- ◆ Housing, Cover and Worm Wheel material also available in Ductile Iron/Carbon Steel/Stainless Steel/Nickel Aluminium Bronze material or as required as optional.
- ◆ Worm and Shaft are also available in Stainless Steel, Aluminium Bronze (AB1/AB2) material as optional.
- ◆ Fasteners and Hand wheel also available in Stainless Steel as optional.
- ◆ Grease Nipple, Padlock Arrangement and Chain Wheel Arrangement also available as optional.
- ◆ Buried Service Gear Boxes with Extension Shaft Arrangement also available.
- ◆ IP-68 Enclosure available against requirement.
- ◆ Limit Switch Box Fitment Mounting also available.
- ◆ Gear Boxes for Low Temperature and High Temperature applications also available.
- ◆ Half Turn (180°) and Multit-Turn (360°) operational gear boxes also available.
- ◆ RL - Version Optional.

TESTING FACILITIES:

- ◆ Test Rig to measure the Performance Factor (P.F)
- ◆ Endurance test Setup

PERFECT ACTUATORS & CONTROLS PVT. LTD.

(An ISO 9001 : 2015 Certified Company)

B-137/493, INDUSTRIAL ESTATE, GOKUL ROAD. HUBLI - 580 030. INDIA

PHONE : 0836 - 2335971, 2210619. FAX : (0836) 2331698

E-Mail : sales@pacplindia.com, info@pacplindia.com. Website : www.pacplindia.com

a) Standard Gear Box

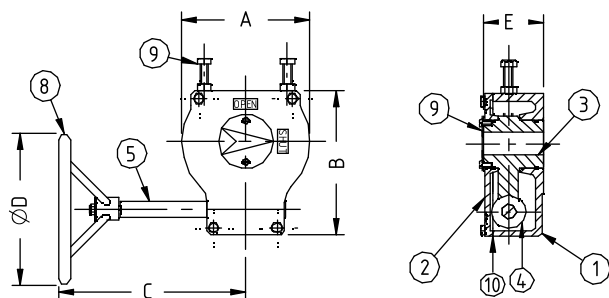

Sl. No.	Description	Material*
01	Housing	CI FG-220
02	Cover	CI FG-220
03	Wormwheel	SGI 600/3
04	Worm	EN-8
05	Shaft	EN - 8
06	SG Casing	CI FG-220
07	SG Gears	EN - 8
08	Hand Wheel	MS Fab
09	Fasteners	8.8 Grade
10	Gasket	AF-111/RTV Sealant

b) Gear Box with Secondary Gear Attachment

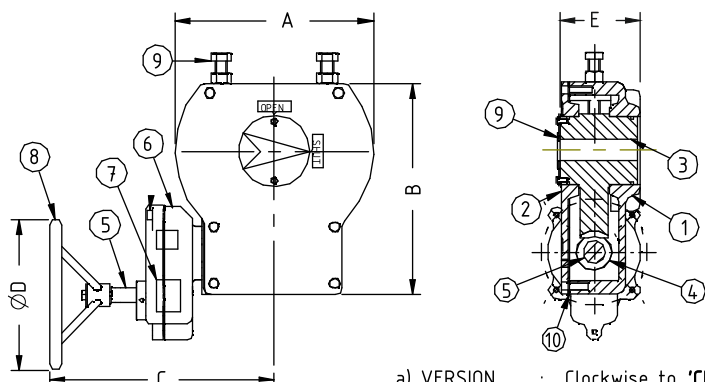

Note - a)* Material optional as required
b) Performance Factor achieved after 10 cycles
c) All dimension are in mm & indicative

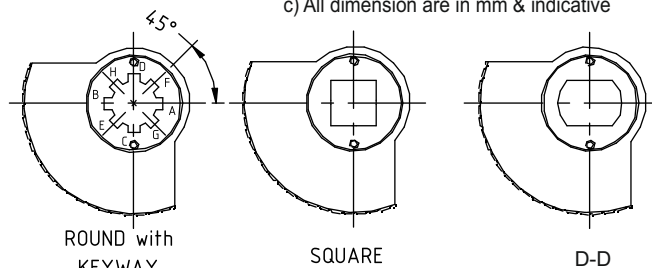

a) VERSION : Clockwise to 'Close'
Anticlockwise to 'Open'
b) IP enclosure : IP - 67

View Seen From Top at 'Close' Position

MODEL	RATIO	TURNS TO CLOSE 90 °	PERFORMANCE FACTOR ±10%	MAX. OUTPUT TORQUE		DIA. OF DRIVE BORE MAX. (mm)	MOUNTING FLANGE AS PER ISO:5211		HANDWHEEL Ø D (mm)	Aprx. Wgt. (Kg.)	A	B	C	E
				Nm	Kgm		Min.	Max.						
QT-25	30 : 1	7.5	8	245	25	20	F05	F07	200	2.0	77.0	102.0	168.0	55.0
QT-35	32 : 1	8	10	343	35	30	F07	F10	250	3.2	88.0	116.0	208.0	57.0
QT-45	32 : 1	8		440	45	30					91.0	118.0	210.0	57.0
QT-50	40 : 1	10	11	490	50	36	F10	F12	300	4.0	104.0	137.0	226.0	59.0
QT-70	50 : 1	12.5	13	690	70	36			F14	400	5.2	125.0	149.0	266.0
QT-100	40 : 1	10	11	981	100	45.5	F16	F16			8	127.0	158.0	264.0
	40 : 1	10				45.5			150.0	176.0		264.0	83.0	
QT-150	56 : 1	14	14	1470	150	45.5	F10	F14	450	10.5	170.0	189.0	315.0	81.0
	56 : 1	14				45.5	F16	F16		11	170.0	200.0	315.0	91.0
	56 : 1	14				60	F25	F25		14	170.0	189.0	315.0	88.0
QT-190	56 : 1	14	13	1860	190	57.5	F12	F16	600	16	190.0	255.0	345.0	93.0
	56 : 1	14				60	F25	F25		19.5	266.0	276.0	345.0	101.0
QT-225	52 : 1	13	12	2208	225	57.5	F12	F16	600	16.5	189.0	222.0	347.0	93.0
	52 : 1	13				60	F25	F25		20.5	266.0	275.0	347.0	101.0
QT-280	58 : 1	14.5	15	2745	280	57.5	F12	F16	600	20	210.0	240.0	362.0	105.0
	58 : 1	14.5				60	F25	F25		23	266.0	288.0	362.0	105.0
QT-330	60 : 1	15	16	3236	330	68	F12	F16	700	22	230.0	249.0	374.0	104.0
	60 : 1	15				75	F25	F25		26	266.0	303.0	374.0	107.5
QT-400	56 : 1	14	14	3924	400	75	F16	F16	700	28	268.0	255.0	364.0	110.0
	56 : 1	14				75	F25	F25			268.0	305.0	364.0	110.0
QT-330SG	150 : 1	37.5	30	3236	330	68	F12	F16	600	26	230.0	249.0	365.0	104.0
	150 : 1	37.5				75	F25	F25		29	266.0	303.0	365.0	107.5
QT-400SG	168 : 1	42	32	3924	400	75	F16	F16	600	31	268.0	255.0	355.0	110.0
	168 : 1	42				75	F25	F25		35	268.0	305.0	355.0	110.0
QT-500SG	252 : 1	63	50	4905	500	65	F16	F16	600	34	265.0	288.0	366.0	112.0
	252 : 1	63				80	F25	F25		37	265.0	323.0	366.0	112.0
QT-650SG	264 : 1	66	60	6376	650	80	F16	F16	650	46	280.0	280.0	363.0	107.0
	264 : 1	66				80	F25	F25		49	280.0	320.0	363.0	130.0
QT-850SGP	318 : 1	79.5	75	8338	850	80	F16		F25	650	64	330.0	315.0	439.0
QT-1100SGP	336 : 1	84	80	10790	1100	90	F25	F30			82	355.0	340.0	414.0
QT-1500SGD	504 : 1	126	100	14715	1500	100			95	345.0	425.0	445.0	165.0	
QT-2400SG	522 : 1	130.5	115	23540	2400	115	F30	F35	750	137	430.0	518.0	462.0	159.0
QT-3500SG	1056 : 1	264	210	34335	3500	150				210	484.0	547.0	492.0	162.0
QT-5000SGC	960 : 1	240	200	49050	5000	160	F30	F40	800	400	548.0	928.0	692.0	212.0
	1500 : 1	375	320			160					548.0	928.0	692.0	212.0
QT-7500SGC	1325 : 1	331.25	310	73575	7500	200	F40	F48	800	450	600.0	1060.0	725.0	210.0
	1908 : 1	477	415			200					600.0	1060.0	725.0	210.0